

Specifications

备注(Remark)
 1. 材料(MATERIAL)
 胶芯: LCP+30%G.F UL94V-0, 颜色:黑色.
 Housing:LCP+30%G.F UL94V-0,Color:Black
 四方针: 黄铜, 镍底30u"MIN, 镀普通锡
 Contact:Brass,ORDINARY TIN PLATED
 30u" MIN NICKEL UNDERPLATING OVER ALL

2. 特性 (characteristics):
 额定电流: 7 AMP
 Raring Current:7 AMP.
 接触阻抗: 20 mΩ MAX.
 Contact Resistance:20mΩ MAX.
 绝缘阻抗: 1000 MΩ MIN.
 Insulating Resistance:1000 MΩ MIN.
 耐电压: AC 500V.
 Withstanding Voltage:AC 500V.
 温度范围: -40°C to+105°C
 Temperture Range: -40°C to+105°C

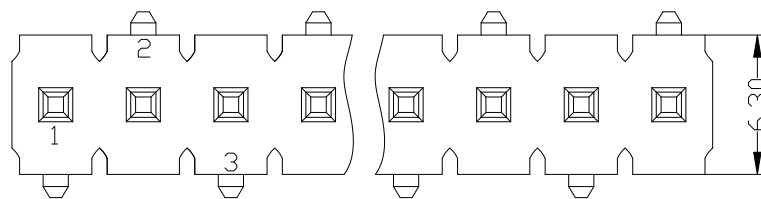

TYPE 1

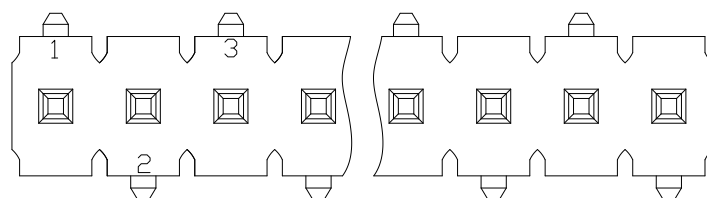

TYPE 2

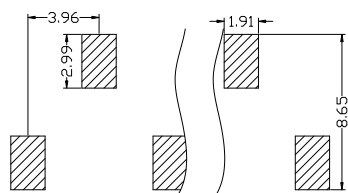

TYPE 1

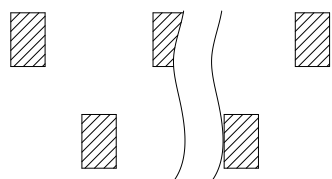

TYPE 2

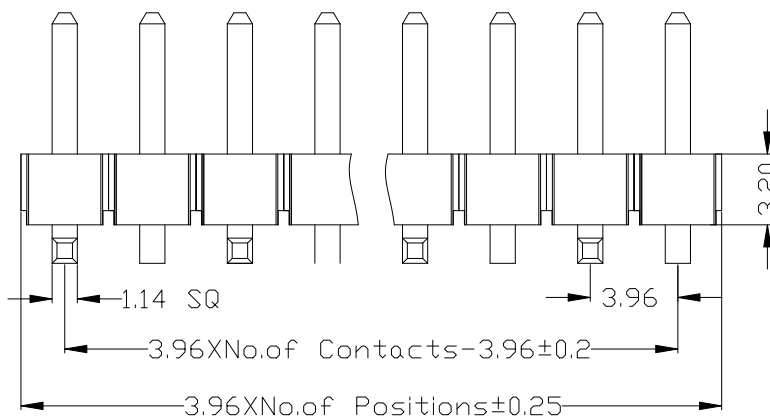

Ordering Information

P732-11 XX XX D M XXX

HEIGHT OF HOUSING	NO.OF PINS PER ROW	Contact Plating		INSULATOR MATERIAL:	LENGTH OF TERMINAL	PACKING	1:TYPE1	2:TYPE2
32:3.2mm	1-30P	Full Of Gold	Semi-gold	D:LCP		A:PE Bag		
		A0=0.8u"	B0=0.8U"			B:Tape & Reel		
		A1=1u"	B1=1U"			C:Tube		
		A2=1.5u"	B2=1.5U"			D:Tube+CAP		
		A3=2u"	B3=2U"			E:Tray		
		A4=3u"	B4=3U"					
		A5=5u"	B5=5U"					
		A6=10u"	B6=10U"					
		A7=15u"	B7=15U"					
		A8=20u"	B8=20U"					
		A9=30u"	B9=30U"					
		S1=Ordinary Tin Plated						
		S2=Matte Tin Plated						
		S3=Tin-plated High-temperature						

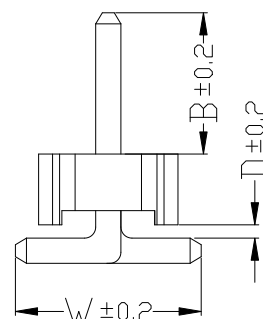

Dimension antitheses list			
ITEM	W	B	D
Standard	8.40	4.5	0.60
Alternate			

上海高霖电子有限公司

卢小强 PART NO. P732-11XXXXDMXXXXX

TITLE: 3.96mm 单排针 塑高3.2 SMT

Customer No.

REV	DATE	MODIFICATION DESCRIPTION	CHANGE	APPROVE	OPERATION		SCALE		Fit
					X.X	±0.25	UNIT	MM	
					X.XX	±0.20	SIZE	A4	DESIGN
					X.XXX	±0.10	SHEET	1/1	CHECK
					Angle	±3°	PROJ.		APPROVE
					DIM	TOL			

Specifications

备注 (Remark)

1. 材料 (MATERIAL)

胶芯: LCP+30%G.F UL94V-0, 颜色: 黑色.

Housing: LCP+30%G.F UL94V-0, Color: Black

四方针: 黄铜, 镍底30u"MIN, 镀普通锡

Contact: Brass, ORDINARY TIN PLATED

30u" MIN NICKEL UNDERPLATING OVER ALL

2. 特性 (characteristics):

额定电流: 7 AMP

Rating Current: 7 AMP.

接触阻抗: 20 mΩ MAX.

Contact Resistance: 20mΩ MAX.

绝缘阻抗: 1000 MΩ MIN.

Insulating Resistance: 1000 MΩ MIN.

耐电压: AC 500V.

Withstanding Voltage: AC 500V.

温度范围: -40°C to +105°C

Temperture Range: -40°C to +105°C

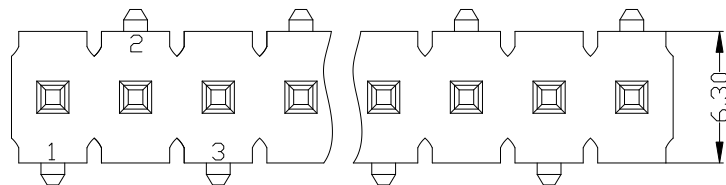

TYPE 1

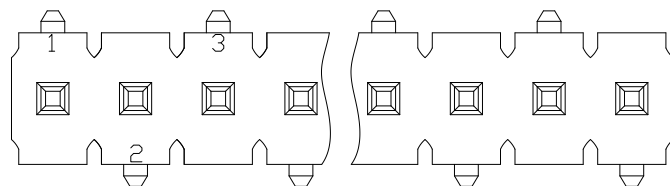

TYPE 2

Ordering Information

P732-21 XX XX D M XXX AX

HEIGHT OF HOUSING	NO. OF PINS PER ROW	Contact Plating		INSULATOR MATERIAL:	LENGTH OF TERMINAL	PACKING	1:TYPE1
32:3.2mm	1-30P	Full Of Gold	Semi-gold	D:LCP		A:PE Bag B:Tape & Reel C:Tube D:Tube+CAP E:Tray	2:TYPE2
		A0=0.8u"	B0=0.8U"				
		A1=1u"	B1=1U"				
		A2=1.5u"	B2=1.5U"				
		A3=2u"	B3=2U"				
		A4=3u"	B4=3U"				
		A5=5u"	B5=5U"				
		A6=10u"	B6=10U"				
		A7=15u"	B7=15U"				
		A8=20u"	B8=20U"				
		A9=30u"	B9=30U"				
		S1=Ordinary Tin Plated					
		S2=Matte Tin Plated					
		S3=Tin-plated High-temperature					

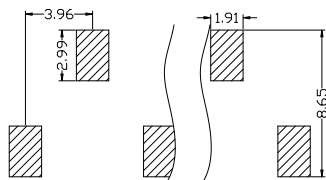

TYPE 1

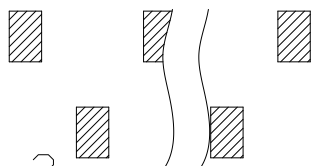

TYPE 2

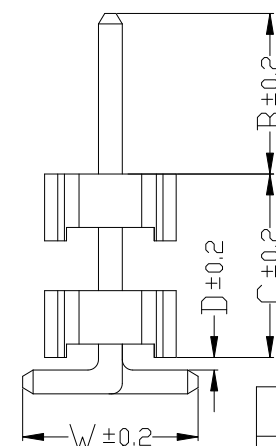
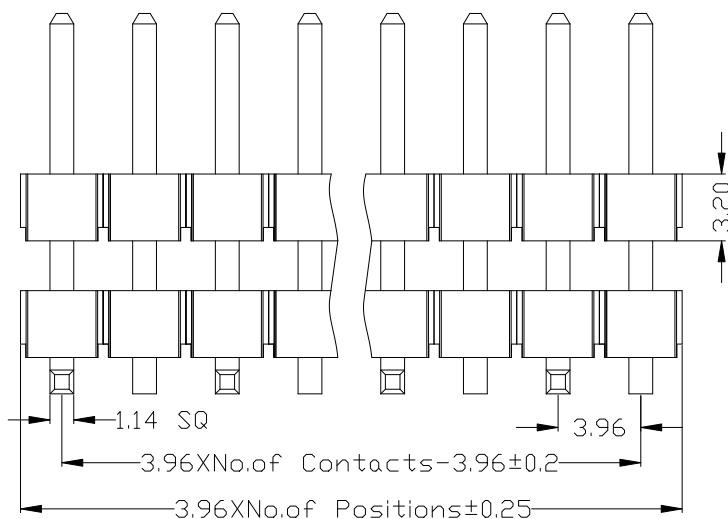

Dimension antitheses list				
ITEM	W	B	D	C
Standard	8.40	4.5	0.60	
Alternate				

REV	DATE	MODIFICATION DESCRIPTION	CHANGE	APPROVE	OPERATION		SCALE		Fit	
					X.X	±0.25	UNIT	MM		
					X.XX	±0.20	SIZE	A4	DESIGN	卢小强
					X.XXX	±0.10	SHEET	1/1	CHECK	PART NO.
					Angle	±3°	PROJ.	☉	APPROVE	TITLE:
					DIM	TOL				Customer No.

上海高霖电子有限公司

卢小强 PART NO. P732-21XXXXDMXXXXX

CHECK TITLE: 3.96mm 单排针 双塑 塑高3.2 SMT

APPROVE