

1 2 3 4 5 6 7 8 9 10

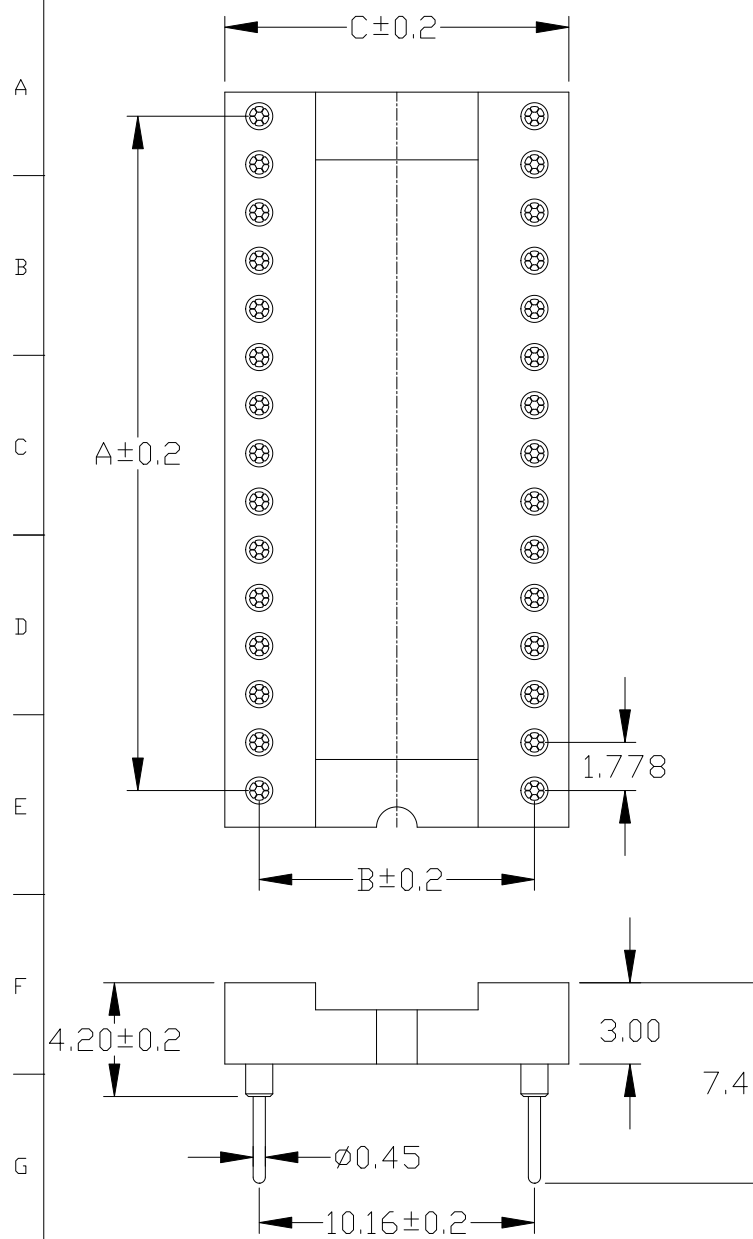

See page 33	No. of Positions	A	B	C
fig. 1	24	21.8	10.16	12.7
fig. 2	28	25.2	10.16	12.7
fig. 3	30	27.0	10.16	12.7
fig. 4	32	28.8	10.16	12.7
fig. 5	48	43.1	10.16	12.7
fig. 6	20	18.1	15.24	17.64
fig. 7	24	21.7	15.24	17.64
fig. 8	28	25.2	15.24	17.64
fig. 9	40	35.8	15.24	17.64
fig. 10	42	37.7	15.24	17.64
fig. 11	48	43.1	15.24	17.64
fig. 12	52	46.7	15.24	17.64
fig. 13	56	50.2	15.24	17.64
fig. 14	64	57.3	15.24	17.64
fig. 15	68	60.9	15.24	17.64
fig. 16	64	57.3	19.05	21.45

Ordering Information

RF430-2 XX 5 X X S 074

C 1

HEIGHT OF HOUSING: 1: Single-Row 30: 3.0mm
 NO. OF PINS PER ROW: 2: Dual-Row 3: Three Rows of 2-40P
 0: No Pitch 1: 1.27
 A=1u" B=2u" C=5u" D=10u" E=15u" F=30u"
 A: PBT B: PA6T C: PA9T D: LCP G: PPS
 LENGTH OF TERMINAL: S= Ordinary Tin Plated H= Half gold plated Tin

Specifications

Insulator : Black glass filled polyester PPS-GF30-FR
 Flammability : UL94V-0
 Sleeve : Brass CuZn 36Pb3(36000)
 Contact cilp (6 finger) : Beryllium copper (C17200)
 Mating pin Ø : 0.40 to 0.56 mm
 Forces : (polished steel gauge Ø0.46mm)
 -Insertion : 2 N typ.
 -Withdrawal : 1 N typ.
 Mechancial life : min 100 cycles
 Rated current : 1Amp
 Contact resistance: Max 10mΩ
 Dielectric resistance : Min 1000V_{RMS}

					OPERATION		SCALE		Fit		上海高霖电子有限公司			
					X.X	±0.25	UNIT		MM					
					X.XX	±0.20	SIZE	A4	DESIGN		卢小强		PART NO.	RF430-2XX5XXS074C1
					X.XXX	±0.10	SHEET	1/1	CHECK				TITLE:	1.778圆孔 IC座 塑高3.0 L=7.4/3.2
REV	DATE	MODIFICATION DESCRIPTION		CHANGE	APPROVE	DIM	TOL	PROJ.	⊕	APPROVE			Customer No.	
1														

1 2 3 4 5 6 7 8 9 10