

1 2 3 4 5 6 7 8 9 10

Ordering Information

RF228-X XX X X X R AXX

HEIGHT OF HOUSING	1:Single-Row	NO. OF PINS PER ROW	0:No Pitch	A=1u"	A:PBT	LENGTH OF TERMINAL
28:2.8mm	2:Dual-Row	1~40P	1:1.27	B=2u"	B:PA6T	
	3:Three Rows of	2~40P	2:2.00	C=5u"	C:PA9T	
			3:2.54	D=10u"	D:LCP	
			4:7.62	E=15u"	G:PPS	
			5:10.16	F=30u"		
			6:15.24	S=Ordinary Tin Plated		
			7:22.86	H=Half gold plated Tin		

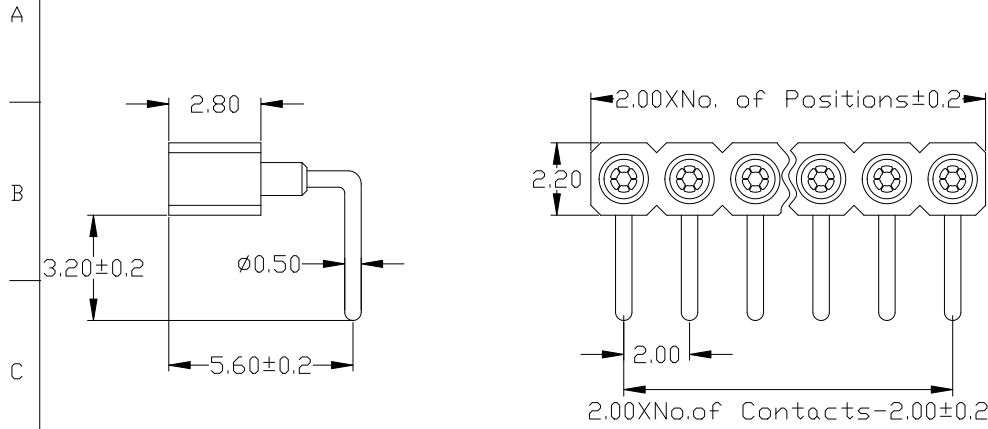

Right socket connector:solder tail
single row
Availability from:2 to 40 contacts
Standard number of contacts 40

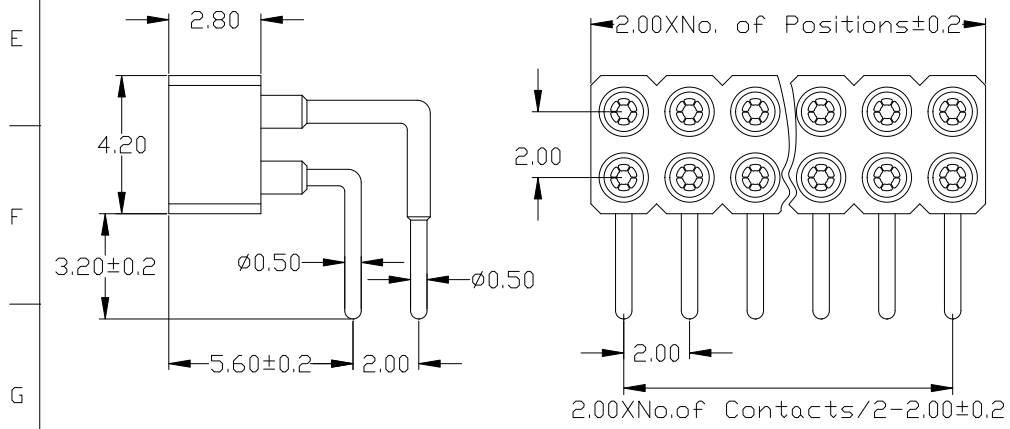

Right socket connector:solder tail
double row
Availability from:4 to 80 contacts
Standard number of contacts 80

Specifications

Insulator : Black glass filled polyester PPS-GF30-FR
Flammability : UL94V-0
Sleeve : Brass CuZn 36Pb3(36000)
Contact cilp (6 finger) : Beryllium copper (C17200)
Mating pin Ø : 0.40 to 0.66 mm or 0.50SQ
Forces : (polished steel gauge Ø0.46mm)
-Insertion : 0.7 N typ.
-Withdrawal : 0.4N typ.
Mechanical life : min 500 cycles
Rated current : 3Amp
Contact resistance: Max 10mΩ
Dielectric resistance : Min 1000V_{RMS}

					OPERATION		SCALE		Fit		上海高霖电子有限公司			
					X.X	±0.25	UNIT		MM					
					X.XX	±0.20	SIZE	A4	DESIGN	卢小强	PART NO.	RF228-XXXXXXRXXX1		
					X.XXX	±0.10	SHEET	1/1	CHECK		TITLE:	2.0圆孔排母 塑高2.8 90度		
					Angle	±3°	PROJ.	☉	APPROVE		Customer No.			
REV	DATE	MODIFICATION DESCRIPTION	CHANGE	APPROVE	DIM	TOL								
1														
2														
3														
4														
5														
6														
7														
8														
9														
10														