

### Ordering Information

RF130-2 XX X X X S XXX

HEIGHT OF HOUSING: 1:Single-Row 30:3.0mm  
 NO. OF PINS PER ROW: 2: Dual-Row 3: Three Rows of 2~40P  
 0: No Pitch 1:1.27 2:2.00 3:2.54 4:7.62 5:10.16 6:15.24 7:22.86  
 A=1u" B=2u" C=5u" D=10u" E=15u" F=30u"  
 A:PBT B:PA6T C:PA9T D:LCP G:PPS  
 S:Ordinary Tin Plated H:Half gold plated Tin

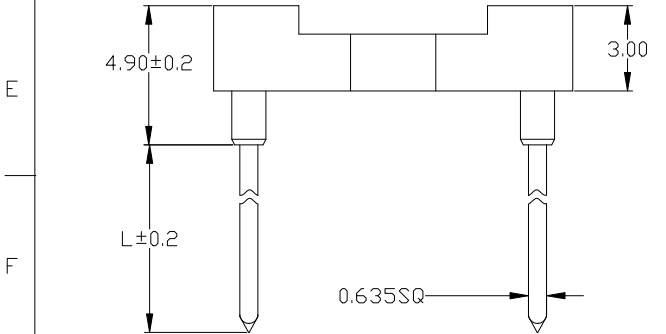
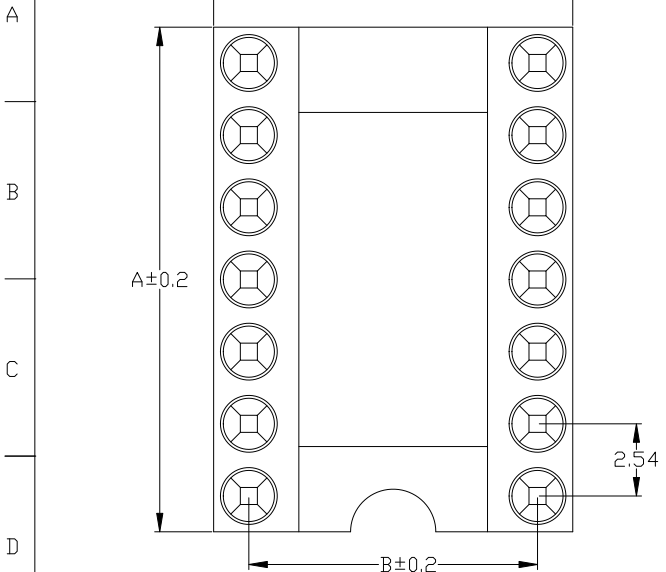

Contact length L:  
 6.6mm, 9.4mm, 12.9mm, 16.0mm

| See page 33 | No. of Positions | A    | B    | C    |
|-------------|------------------|------|------|------|
| fig. 1      | 6                | 7.6  | 7.62 | 10.1 |
| fig. 2      | 8                | 10.1 | 7.62 | 10.1 |
| fig. 3      | 10               | 12.6 | 7.62 | 10.1 |
| fig. 4      | 12               | 15.2 | 7.62 | 10.1 |
| fig. 5      | 14               | 17.7 | 7.62 | 10.1 |
| fig. 6      | 16               | 20.3 | 7.62 | 10.1 |
| fig. 7      | 18               | 22.8 | 7.62 | 10.1 |
| fig. 8      | 20               | 25.3 | 7.62 | 10.1 |
| fig. 9      | 22               | 27.8 | 7.62 | 10.1 |
| fig. 10     | 24               | 30.4 | 7.62 | 10.1 |
| fig. 11     | 28               | 35.5 | 7.62 | 10.1 |

|         |    |      |       |      |
|---------|----|------|-------|------|
| fig. 12 | 20 | 25.4 | 10.16 | 12.6 |
| fig. 13 | 22 | 27.8 | 10.16 | 12.6 |
| fig. 14 | 24 | 30.4 | 10.16 | 12.6 |
| fig. 15 | 28 | 35.5 | 10.16 | 12.6 |
| fig. 16 | 32 | 40.6 | 10.16 | 12.6 |

|         |    |      |       |      |
|---------|----|------|-------|------|
| fig. 17 | 24 | 30.5 | 15.24 | 17.7 |
| fig. 18 | 28 | 35.5 | 15.24 | 17.7 |
| fig. 19 | 32 | 40.6 | 15.24 | 17.7 |
| fig. 20 | 36 | 45.7 | 15.24 | 17.7 |

|         |    |      |       |      |
|---------|----|------|-------|------|
| fig. 21 | 40 | 50.8 | 15.24 | 17.7 |
| fig. 22 | 42 | 53.3 | 15.24 | 17.7 |
| fig. 23 | 48 | 60.9 | 15.24 | 17.7 |
| fig. 24 | 50 | 63.5 | 15.24 | 17.7 |
| fig. 25 | 52 | 66.0 | 15.24 | 17.7 |

|         |    |      |       |      |
|---------|----|------|-------|------|
| fig. 26 | 50 | 63.5 | 22.86 | 25.3 |
| fig. 27 | 52 | 66.0 | 22.86 | 25.3 |
| fig. 28 | 64 | 82.1 | 22.86 | 25.3 |

### Specifications

Insulator : Black glass filled polyester PPS-GF30-FR  
 Flammability : UL94V-0  
 Sleeve : Brass CuZn 36Pb3(36000)  
 Contact cilp (4 finger) : Beryllium copper (C17200)  
 Mating pin Ø : 0.40 to 0.56mm  
 Forces: (polished steel gauge Ø0.43mm)  
 -Insertion : 2 N typ.  
 -Withdrawal: 1 N typ.  
 Mechancial life : min 100 cycles  
 Rated current : 1Amp  
 Contact resistance: Max 10mΩ  
 Dielectric resistance : Min 1000V<sub>RMS</sub>

|     |      |                          |  |        | OPERATION |       | SCALE |       | Fit    |          | 上海高霖电子有限公司   |                       |  |
|-----|------|--------------------------|--|--------|-----------|-------|-------|-------|--------|----------|--------------|-----------------------|--|
|     |      |                          |  |        | X.X       | ±0.25 | UNIT  |       | MM     |          |              |                       |  |
|     |      |                          |  |        | X.XX      | ±0.20 | SIZE  | A4    | DESIGN | PART NO. |              |                       |  |
|     |      |                          |  |        | X.XXX     | ±0.10 | SHEET | 1/1   | CHECK  | TITLE:   |              |                       |  |
| REV | DATE | MODIFICATION DESCRIPTION |  | CHANGE | APPROVE   | Angle | ±3°   | PROJ. | ⊕      | APPROVE  | Customer No. |                       |  |
|     |      |                          |  |        |           | DIM   | TOL   |       |        |          |              | RF130-2XXXXXSXXXC3    |  |
|     |      |                          |  |        |           |       |       |       |        |          |              | 2.54圆孔 IC座 塑高3.0 180度 |  |